

SITE SAFETY INFO

Personal Protective Equipment

- Hard hats (if outside vehicle)
- Safety glasses (if outside vehicle)
- Safety boots (steel-cap)
- High-visibility clothing (Australian Standards compliant)
- P2 dust masks (if airborne dust present)

Safety Rules

- Drivers must communicate over radio before entering shed
- All trucks must have roll over tarps
- As this terminal is in a quarantine site, any carrier that arrives on site with an unclean truck (wheat, barley etc.) will be turned away
- Do not wander around site unescorted
- Comply with Traffic Management Plan
- Obey all speed and warning signs
- Be aware of uneven surfaces, slip & trip hazards

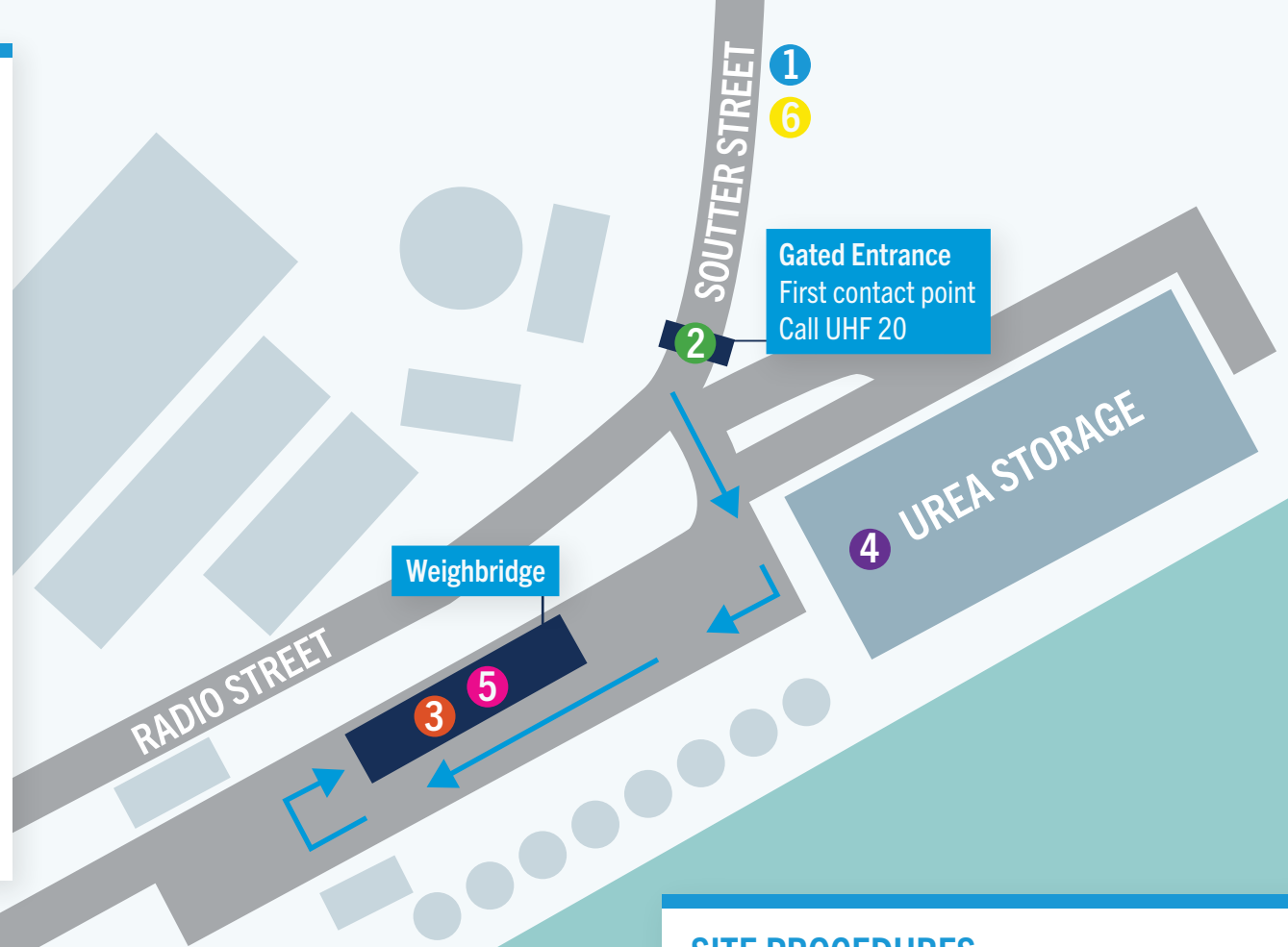

KOCH PINKENBA (GRAINCORP) SITE GUIDE

34 Soutter Street, Pinkenba, QLD, 4008

Operating hours

6:00am – 2:30pm Monday – Friday
(subject to change)

Truck must be on weighbridge
by no later than 2:00pm

UHF channel 20

SITE PROCEDURES

- 1 Enter site at Soutter Street
- 2 Call UHF 20 before proceeding to weighbridge
- 3 Weigh on at weighbridge
- 4 Proceed to urea store as instructed by weighbridge operator
- 5 Weigh off at weighbridge
- 6 Exit site via Soutter Street